



# RUT955 LTE Router

Quick start guide v11.0



## Front view



- 1 LAN Ethernet ports
- 2 WAN Ethernet port

- 3 LAN LEDs
- 4 WAN LED
- 5 RS485 interface
- 6 Power socket
- 7 RS232 interface
- 8 Input/output connector
- 9 Power LED
- 10 Mobile connection status LED
- 11 Mobile signal strength indication LEDs

## Back view



- 1 LTE antenna connectors
- 2 GPS antenna connector
- 3 USB connector
- 4 WiFi antenna connectors
- 5 Reset button

## Hardware installation

1. Remove back panel and insert SIM cards which were given by your ISP (Internet Service Provider). Correct SIM cards' orientation is shown in the picture below.

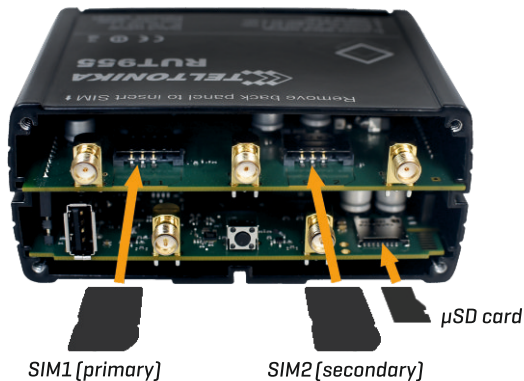

2. Attach LTE, WiFi and GPS antennas.
3. Connect the power adapter to the socket on the front of the device. Then plug the other end of the power adapter into the power socket.
4. Connect to the device wirelessly (SSID: RUT955\_\*\*\*\*) or use Ethernet cable and plug it in to any LAN Ethernet port.

## Configure your computer (Windows)

1. Enable the wireless network connection (go to **Start > Control Panel > Network and Internet > Network and Sharing Center**. In the left panel click **Change adapter settings** link. Right click on **Wireless Network Connection** and select **Enable**).
2. Setup wireless network adapter on your computer (right click on **Wireless Network Connection** and select **Properties**. After that select **Internet Protocol Version 4 (TCP/IP)** and click **Properties**).
3. Select **Obtain IP address automatically** and **Obtain DNS server address automatically** if they are not selected. Click **OK**.

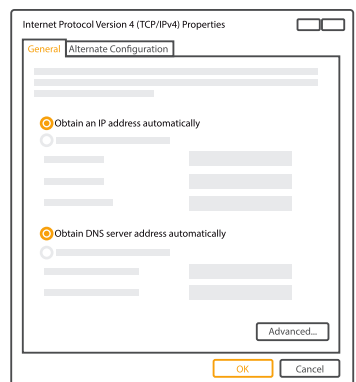
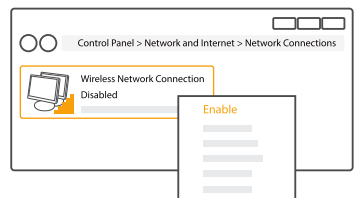

- Right click on [Wireless Network Connection](#) and select [Connect](#) to see available wireless networks.

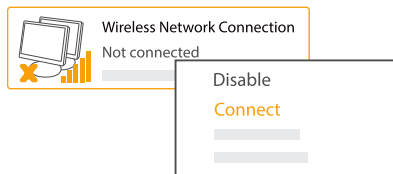

- Choose the wireless network [RUT955\\_\\*\\*\\*\\*](#) from the list and click [Connect](#). Enter the WiFi password located on the device's label.

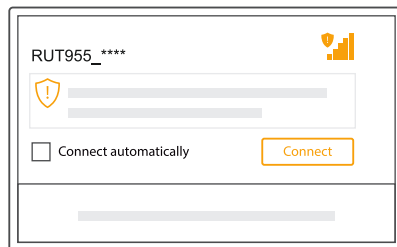

## Login to device

- To enter the router's Web interface (WebUI), type <http://192.168.1.1> into the URL field of your Internet browser.
- Use the following login information when prompted for authentication:

A screenshot of a web browser window. The address bar shows 'http://192.168.1.1'. The main content area displays 'Authorization Required' and asks the user to enter their username and password. The username field is filled with 'admin' and the password field is filled with 'admin01'. There is a 'Login' button below the password field.

Authorization Required

Please enter your username and password

Username

Password

- After you login, you will be prompted to change your password for security reasons. The new password must contain at least 8 characters, including at least one uppercase letter, one lowercase letter and one digit. This step is mandatory and **you will not be able to interact with the router's WebUI before you change the password.**
- When you change the router's password, the [Configuration Wizard](#) will start. The [Configuration Wizard](#) is a tool used to setup some of the router's main operating parameters.
- Go to the [Status > Network](#) page and pay attention to the [Signal Strength](#) indication. To maximize the cellular performance try adjusting the antennas or changing the location of your device to achieve the best signal conditions.

Login to device

Mobile

WAN

LAN

Wireless

OpenVPN

Mobile Information

Mobile



Data connection state	Connected
IMEI	868323023148973
IMSI	246021004265840
Sim card state	Ready
Signal strength	-79 dBm

Safety information

RUT955 router must be used in compliance with any and all applicable national and international laws and with any special restrictions regulating the utilization of the communication module in prescribed applications and environments.

Radio specifications	
RF technologies	GSM, GPRS, EDGE, UMTS/HSPA+, LTE, GNSS, WiFi
Max RF power	33 dBm@GSM, 24 dBm@WCDMA, 23 dBm@LTE, 20 dBm@WiFi
Bundled accessories specifications*	
Power	AC/DC power adapter 9V 1 A, 2 pin plug
GSM/WCDMA/LTE antenna	698-868/1850-2690 MHz, 50 Ω, VSWR<2, gain** 2 dBi, omnidirectional, SMA male connector
WiFi antenna	2400-2483.5 MHz, 50 Ω, VSWR<2, gain** 2 dBi, omnidirectional, RP-SMA male connector
GNSS antenna	1575.42-1602 MHz, 2.2-5VDC, VSWR<1.5, active total gain** 28dB (typ.), RHCP polarization, SMA male connector

\*Order code dependent.

\*\*Higher gain antenna can be connected to compensate for cable attenuation when cable is used. The user is responsible for the compliance with the legal regulations.



This sign on the package means that it is necessary to read the Users Manual before you start using the device.



This sign on the package means that all used electronic and electric equipment should not be mixed with general household waste.



Hereby, Teltonika declares that the radio equipment type RUT955 is in compliance with Directives: 2014/53/EU, 2014/35/EU, 2014/30/EU. The full text of the EU declaration of conformity is available at the following internet address: <http://teltonika.lt/product/rut955/>