

GENERAL USE

ROHN Tapered Steel poles minimize site requirements, lowering lease rates and acquisition costs. They are designed for rapid installation, meeting the demands of today's dynamic communication environments. Whether you are displaying broadband, PCS, security or other lightweight systems, ROHN Tapered Steel Poles offer extremely efficient strength to cost ratio.

FEATURES

- Completely hot dip galvanized after fabrication
- Fast, easy Installation
- Custom designs available for any height or application
- Designed for applications with stringent deflection limitations
- Internal routing of transmission lines
- Each pole ships with the following:
 - (4) 5" x 7" ports with 2 port covers
 - (1) vented cap plate
 - (1) bearing plate welded to bottom
 - (1) safety warning sign
 - (1) pole ID tag
 - attachment clips for step bolts

* Optional items are available and may be ordered separately.

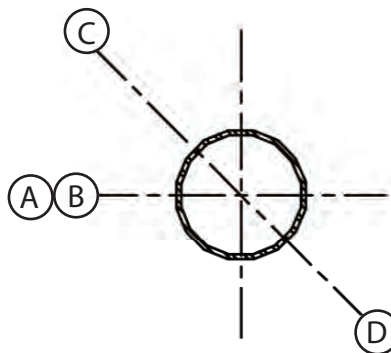

PORT ORIENTATIONS

