

GLOBAL TELECOM LTE TITAN2000 SERIES

Quick Start Guide





Contents

What's in the Box	4
Connect the TITAN2000 Adapter to external router/PC.....	5
Determine Where to Mount Your Adapter.....	6
Mount the Adapter	7
LED Lights Reference	10
Customer Support	11

What's in the Box

TITAN2000 LTE ADAPTER



Mounting Plate

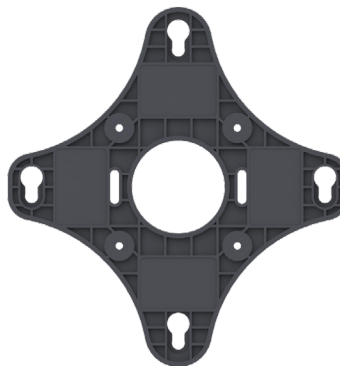

Powered Ethernet Cable

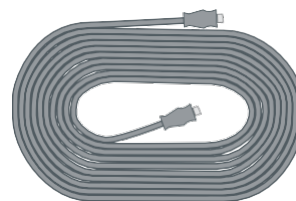

Alcohol Wipe



Screws and Anchors

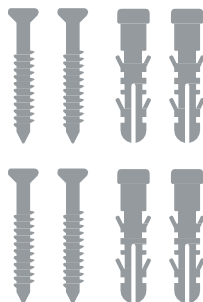

Suctions
Cups

STEP 2

Connect the LTE TITAN2000 Adapter to a PC or a Router

Remove the front panel at the bottom of the LTE TITAN2000 Adapter. To do so, use your fingernail to lift the lever at the bottom of the front panel. Then gently push down in the middle of the front of the panel to slide it off.



Next, connect one end of the powered ethernet cord to the LTE TITAN2000 Adapter and the other end to the LTE connector on the back of the Router/PC



STEP 3

Determine Where to Mount Your Adapter

For the best 4.5G signal, the adapter should be placed in an area with good cellular reception. You can test the reception in various areas using either the signal LEDs on the front of the adapter, or using the mobile app.

Placement recommendations:

- Mount the adapter in a window, if possible.
- Mount the adapter on the highest floor of the building possible.
- Do not place the adapter within five feet of a large metal object, like a water heater or refrigerator.
- Try the adapter in different places within a room, in different rooms, and on different sides of a building.

To test the signal in different locations, simply move the Connect 4G adapter and wait for approximately 10 seconds. The adapter can be connected with a cable up to 250' long (not provided).

STEP 4

Mount the Adapter

Window Mounting Instructions-Adhesive Tape

First, clean the surface with the included alcohol wipes. Do not use household cleaners.

Next, for adhesive tape installation, remove the red side of the included adhesive strips and adhere to the one side of the mounting plate, as pictured. Repeat for the other side.

Finally, remove the black side of both adhesive strips. Press the mounting plate against the window in the desired position and hold it for 30 seconds.

Wait 1 hour before hanging the adapter on the mounting bracket.

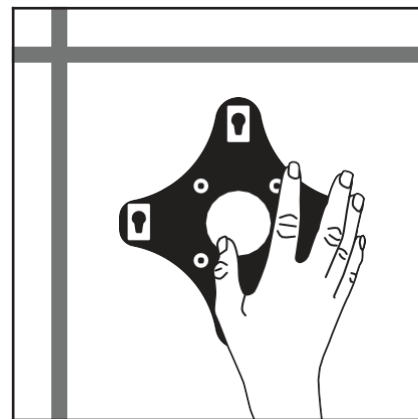
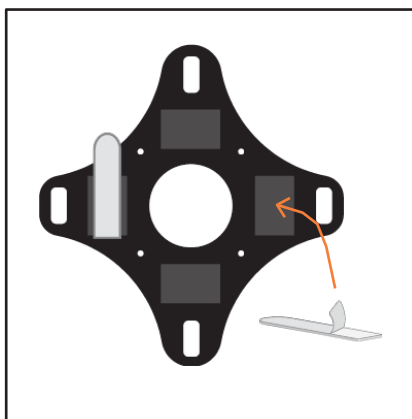
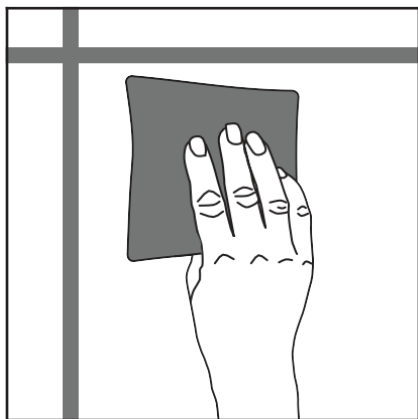

Mount the Adapter

Window Mounting Instructions-Suction Cups

First, clean the surface with the included alcohol wipes. Do not use household cleaners.

Next, for Suction cups installation, remove the screws from suction cups.

Finally, align the suction cups with holes using included screws and tighten the suction cups. Press the mounting plate against the window in the desired position and hold it for 30 seconds.

Wait 1hour before hanging the adapter on the mounting bracket.

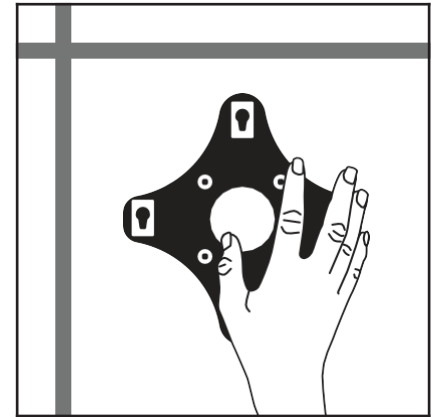
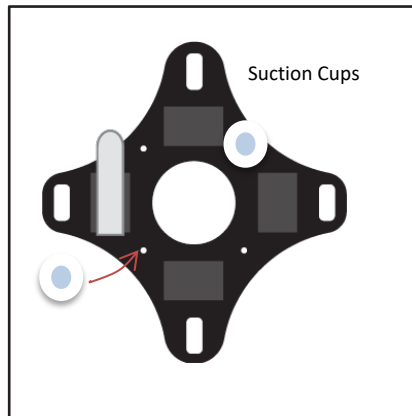
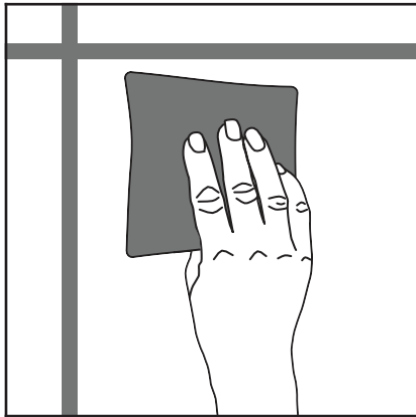

Drywall Mounting Instructions

Hold the mount to the wall in its desired place and mark the holes.

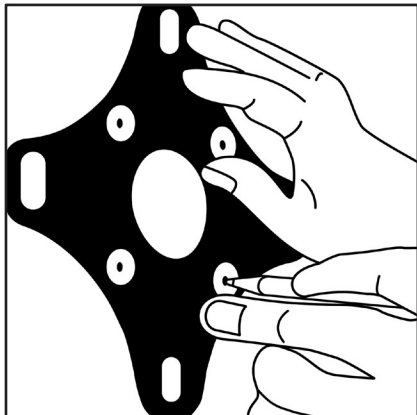

Use a drill to make holes for the anchors.

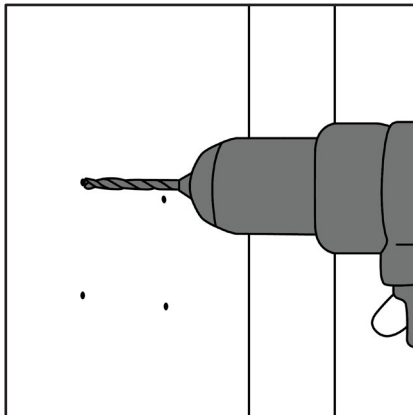

Insert the anchors into the holes. Place the mounting bracket and insert the screws into the anchors.

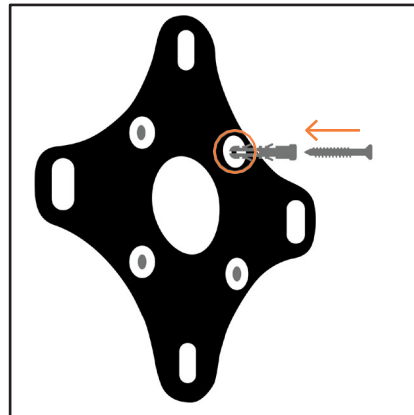

LED Lights Reference

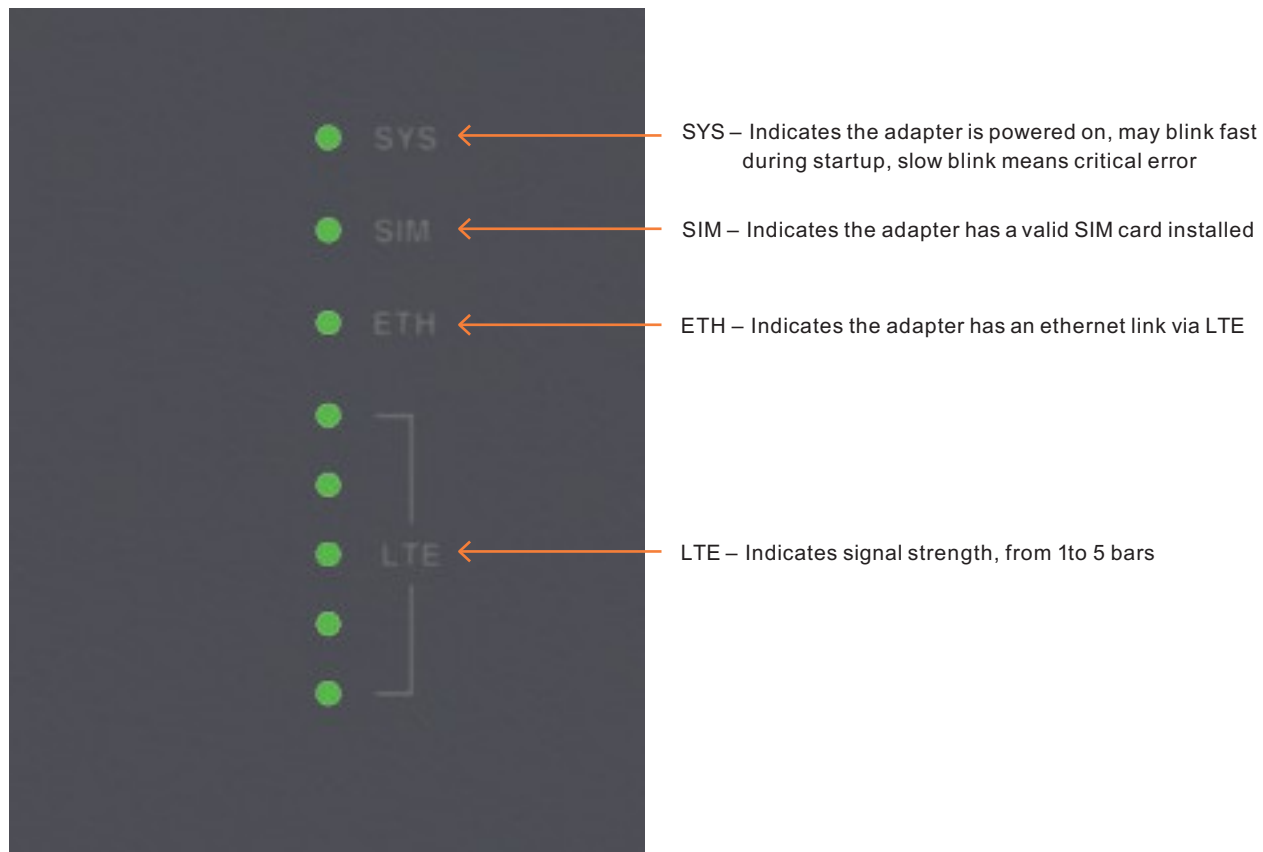

Customer Support

Need help? Global Telecom has a wealth of available resources to help if you need assistance.

Support Articles and User Manuals. Access our comprehensive knowledge base at support@glob-tel.com

GLOBAL TELECOM

For warranty, safety, and other legal information,

This device complies with part 15 of the FCC rules. Operation is subject to the following two conditions: (1) This device may not cause harmful interference, and (2) This device must accept any interference received, including interference that may cause undesired operation.